

systemtronic
datasheet CROMA PLANTER BENCH



General description:

The perfect combination of functionality and beauty. This elegant piece of furniture made in aluminum and available in two sizes can be used both as comfortable seating solution and practical planter offering a natural focal point for decoration.

Designer: Lagranja Design.

Year of launch: 2023.



Technical description:

Materials:

Structure: lacquered aluminium.

Legs: lacquered aluminum / chrome-plated aluminum.

Top: lacquered aluminum / lacquered aluminum + cushion / lacquered aluminum + natural or lacquered ash veneer.

Dimensions:

PLANTER BENCH S: 900x400x430 mm 35.43x15.75x16.93"

PLANTER BENCH M: 1400x400x430 mm 55.12x15.75x16.93"

PLANTER BENCH S

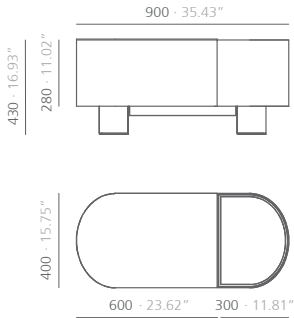

PLANTER BENCH M

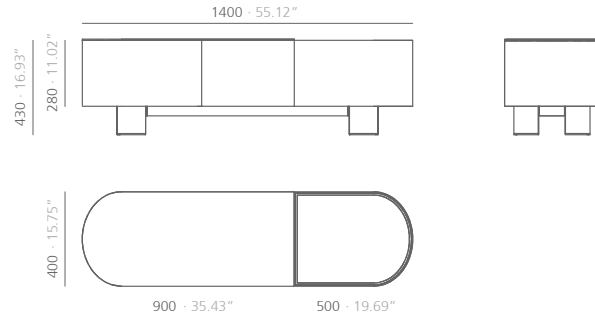

mm · inches

⚠ You can not plant directly in the product. An inner pot and a water-catching plate are required, which are not included in the design.

Finishes:

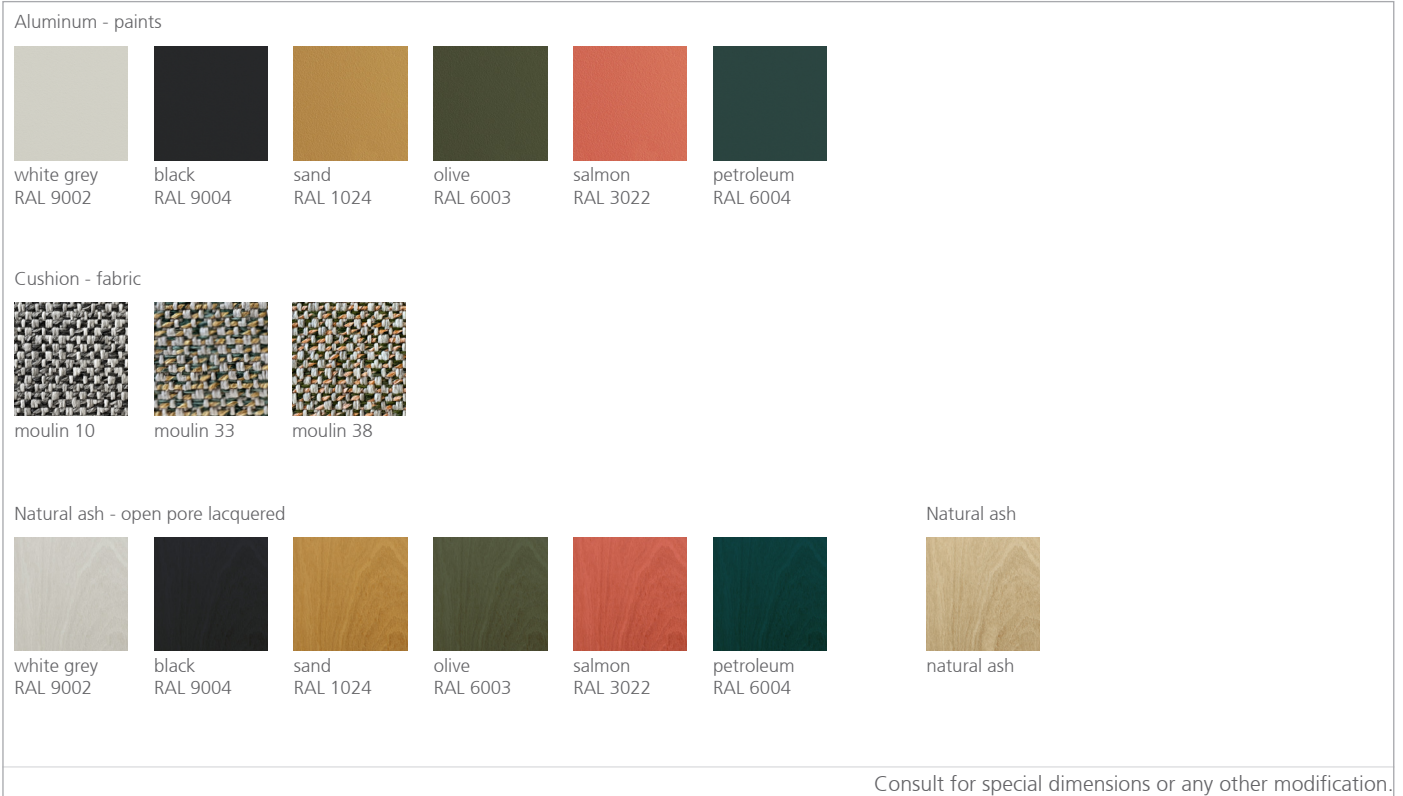

*Polyester paint

Maintenance:

-Polyester Paint:

For dry dirt (dust), use a damp cloth. For greasy/oily stains (fingerprints), wipe with a sponge with water and dishwashing liquid. Rinse with a damp cloth. Avoid using products containing solvents and/or pure ethyl alcohol.

Sustainability:

The Croma collection is committed to sustainability and the preservation of the environment, which is why it uses responsible materials that minimize our impact on the planet. The aluminum used in the collection is 100% recyclable and contains at least 25% recycled material. By using aluminum in our collection, we ensure that items are durable and have a long lifespan, thus reducing the need for short-term replacement. On the other hand, ash wood is a responsible choice due to its renewable origin and its ability to capture and store carbon. Ash is a fast-growing type of wood that is grown sustainably. By using ash wood in our collection we promote the conservation of forests. The incorporated fabrics are composed of 20% recycled fiber. Used paints do not contain solvents, do not consume water and do not generate emissions or discharges. The result is a lower environmental impact.