

systemtronic

datasheet CROMA BIN



General description:

Made of aluminum and available in two different sizes, with capacities of 110 and 170 liters (one 50-liter bag per compartment).

Designer: Lagranja Design.

Year of launch: 2023.



systemtronic _ Croma Bin
www.st-systemtronic.com
comercial@st-systemtronic.com
tel. +34 961 852 784

ASSOCIATED N°00320

AIDIMME
INSTITUTO TECNOLÓGICO

METALMECÁNICO, MUEBLE, MADERA, EMBALAJE Y AFINES



Calidad Controlada

Technical description:

Materials:

Structure: Lacquered aluminum.

Dimensions:

Bin M: 500x364x850 mm 19.69x14.33x33.46"
 Bin L: 750x364x850 mm 29.53x14.33x33.46"

BIN M

BIN L

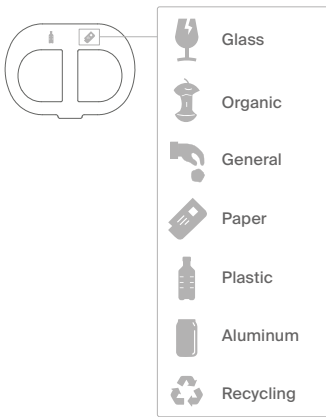
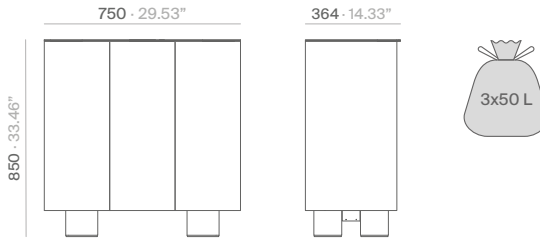
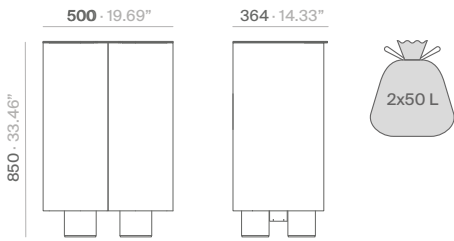

mm · inches

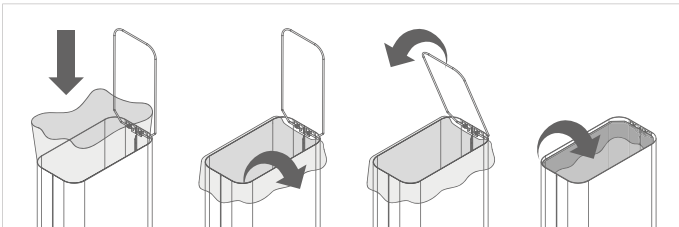

Finishes:



Polyester paint.

Consult for special dimensions or any other modification.

Maintenance:

Polyester powder coating:

For dry dirt (dust), use a cloth dampened with water.

For greasy/oily dirt (fingerprints), use a sponge with water and liquid dish detergent (Vim liquid), then wipe with a cloth dampened with water. Avoid using detergents containing solvents or pure ethyl alcohol.

Aluminum–metal–glass–melamine–plastic materials:

The use of standard commercially available products for delicate surfaces is recommended.

Alcohol, solvents, and abrasive detergents must be strictly avoided.

Pictogram:

When cleaning the pictograms, avoid excessive rubbing. Clean around them with gentle movements and avoid applying too much pressure. Do not use abrasive cleaners or strong chemical products that could damage the vinyl material. After cleaning, dry the bin and the pictograms with a soft, clean cloth. Make sure no moisture remains on the surface.

Sustainability:

The Croma collection is committed to sustainability and the preservation of the environment. For this reason, it uses responsible materials that minimize our impact on the planet. The aluminum used in the collection is 100% recyclable and contains at least 25% recycled material. By using aluminum in our collection, we ensure that the pieces are durable and have a long service life, thus reducing the need for short-term replacement. On the other hand, ash wood is a responsible choice due to its renewable origin and its ability to capture and store carbon. Ash is a fast-growing type of wood that is cultivated sustainably. By using ash wood in our collection, we promote the conservation of forests. The textiles incorporated contain 20% recycled fiber. The paints used are solvent-free, do not consume water, and generate no emissions or waste discharge. The result is a lower environmental impact.