

systemtronic

data sheet CANTHA



Set of hangers that provide the spaces with a practical as well as beautiful complement. Following the philosophy of the search for organic and natural, these sinuous shapes have been created that give the design a touch of elegance and originality, spontaneously recalling dew drops.

Cantha coat racks, made of aluminum, are suitable for any interior design trend due to their wide availability in 4 sizes, 17 colors and with the possibility of adding a natural oak veneer.

Year of launch: 2022.



Paula Chacártegui

Paula Chacártegui is a product design graduate from IED Barcelona, and specialized in luxury design and crafts from the Cantonal School of Art of Lausanne. She currently works in the interior design office am29 in Mallorca, from where she develops products for the island's hotel sector. Paula herself feels a strong attraction to the nature that surrounds her, from which the inspiration for many of her projects is born.



systemtronic _ Cantha
www.st-systemtronic.com
nacional@st-systemtronic.com · export@st-systemtronic.com
tel. 96-1852784 · fax.34-961854482

ASSOCIATED N°00320 **AIDIMME**®
INSTITUTO TECNOLÓGICO METALMECÁNICO, MUEBLE, MADERA, EMBALAJE Y AFINES



Technical description:

Material: Aluminum

Dimensions:

CANTHA S: Ø40x32 mm
 CANTHA M: Ø60x32 mm
 CANTHA L: Ø100x42 mm
 CANTHA XL: Ø140x42 mm

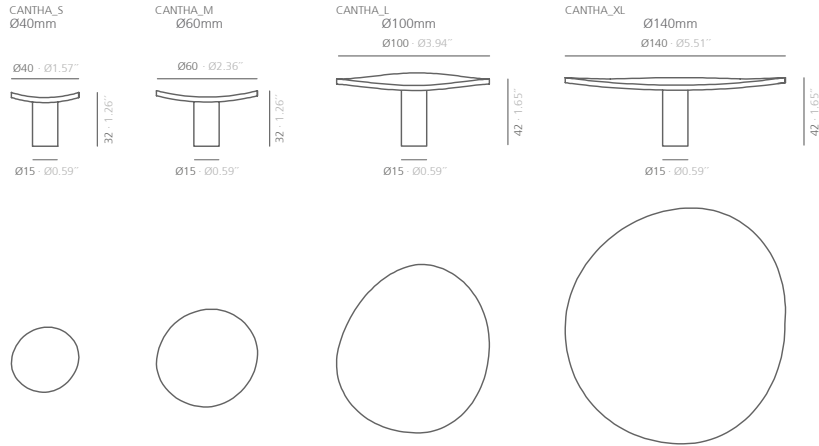

For manufacturing reasons,
 the design may have small variations

mm · inches

systemtronic_Cantha

www.st-systemtronic.com

nacional@st-systemtronic.com · export@st-systemtronic.com

tel. 96-1852784 · fax.34-961854482

ASSOCIATED N°00320

AIDIMME
 INSTITUTO TECNOLÓGICO

METALMECANICO, MUEBLE, MADERA, EMBALAJE Y AFINES



Calidad Controlada

Finishes:

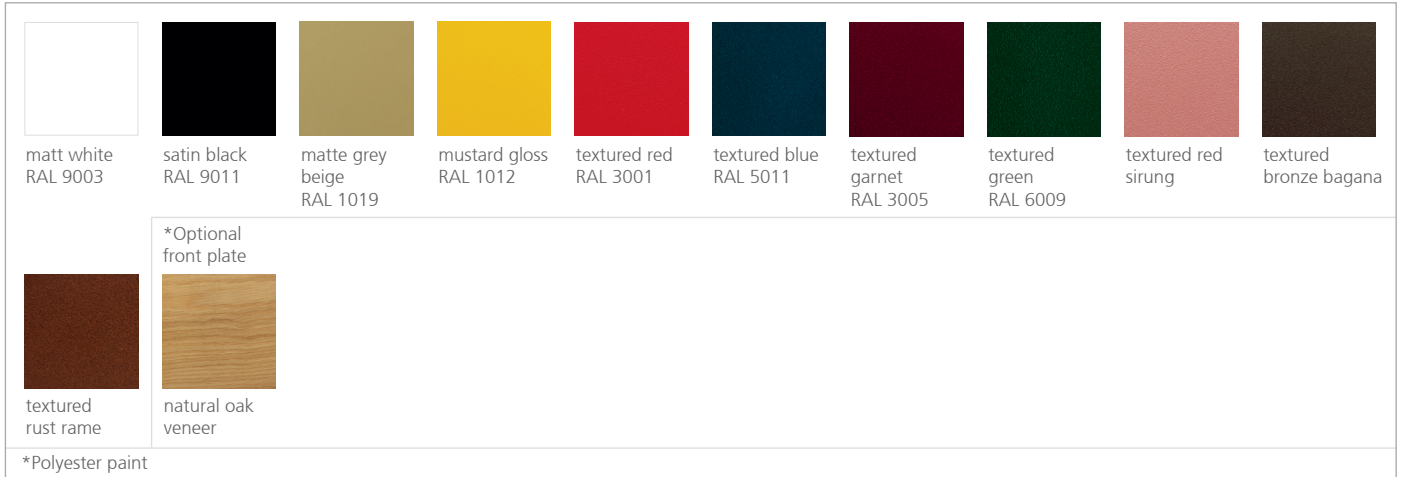

⚠ If you opt for natural oak veneer, you should avoid placing the coat racks in areas exposed to moisture and condensation to prevent deterioration of the wood.

Consult for special dimensions or any other modification.

Maintenance:

-Wood:

We recommend using a cloth or cleaning products for wood. Avoid using products containing solvents and/or alcohol.

-Polyester Paint:

For dry dirt (dust), use a damp cloth. For greasy/oily stains (fingerprints), wipe with a sponge with water and dishwashing liquid. Rinse with a damp cloth. Avoid using products containing solvents and/or pure ethyl alcohol.

-Aluminium-metal-glass-melamine-plastic:

We recommend using normal cleaning products for delicate surfaces. Alcohol, solvents and abrasive agents must be avoided.

Assembly:

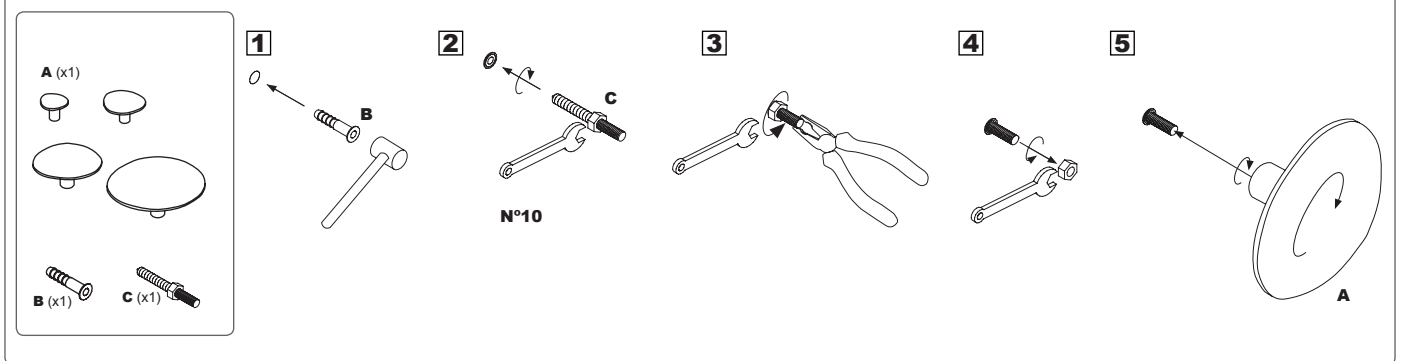

Sustainability:

The flexible and extremely adaptable design of the Cantha collection allows it to be reused, resulting in a longer lifespan. These hangers are made with 100 % recyclable materials. At least 25 % of the aluminum used is recycled. The used paints do not contain solvents, do not consume water and do not generate emissions or waste. The result is a lower environmental impact.

systemtronic _ cantha

www.st-systemtronic.com

nacional@st-systemtronic.com · export@st-systemtronic.com

tel. 96-1852784 · fax.34-961854482

ASSOCIATED N°00320

BAIDIMME
INSTITUTO TECNOLÓGICO

METALMECÁNICO, MUEBLE, MADERA, EMBALAJE Y AFINES



Calidad Controlada